



HYBRID SHRINK FIT HOLDER

Hybrid Shrink Fit Holder can
achieve High Speed, High
Accuracy and Heavy Milling

Easy to fit VMK-SF shrink fit
adaptor using a wrench

The composite structure
moderately reduces vibration
during machining

NICe - NIKKEN Innovation
Centre Europe, Advanced
Manufacturing Park, Brunel
Way, Catcliffe Rotherham, S60
5FS

Tel: +44 (0) 1709 366306
Fax: +44 (0) 1709 376683
Email: info@nikken-world.com



HYBRID SHRINK FIT HOLDER (UNIT CODE)



Mini Mini Master Chuck MMC-ATB

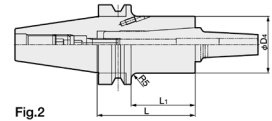
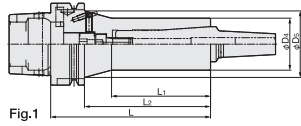

HSK



Taper	Code No.	L	ØD4	ØD5	L1	L2	Collet	Fig	Weight (kg)
HSK63A	HSK 63A-MMC16C-125-ATB	125	40	51.2	76	97	VMK16-SF	1	1.4
	-MMC20C-125-ATB		47	51.3	89		VMK20-SF	1	1.6
HSK100A	HSK100A-MMC16C-132-ATB	132	40	55.5	73.5	101	VMK16-SF	1	2.8
	-MMC20C-132-ATB		47		85.3		VMK20-SF	1	3.0

NBT



Taper	Code No.	L	ØD4	ØD5	L1	L2	Collet	Fig	Weight (kg)
NBT40	NBT40-MMC16C-80-ATB	80	45	-	51	-	VMK16-SF	2	1.4
	-MMC20C-85-ATB	85	50	-	56		VMK20-SF	2	1.5
NBT50	NBT50-MMC16C-80-ATB	80	45	-	40	-	VMK16-SF	2	3.9
	-MMC20C-85-ATB	85	50	-	45		VMK20-SF	2	4.0

VMK SF Shrink Fit Adaptor

VMK-SF

Standard Type

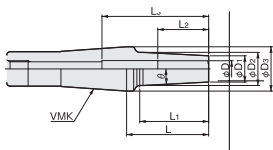

Taper	Code No.	ØD	ØD1	ØD2	ØD3	θ	L	L1	L2	L3	Weight (kg)		
VMK16	VMK16-SF 3S- 50	3	6	10.2	27	3°	50	42	31	10	0.3		
	-SF 4S- 50	4	7	11.2						13			
	-SF 6S- 50	6	9	13.2						19			
	-SF 8S- 50	8	13	17.2						25	0.4		
	-SF 10S- 50			20.2						65			
	-80	10	16	23.4								80	72
	-110			27							110	105	0.5
	SF12S- 50			23.2						50	42	31	0.3
	-80	12	19							80	76.4		0.4
	-110									110		50	0.5
	SF16S- 50			27						50			0.4
	-80	16	24							80	28.7	33	0.5
	-110									110			0.6

High Rigid Type

Taper	Code No.	ØD	ØD1	ØD2	ØD3	θ	L	L1	L2	L3	Weight (kg)		
VMK20	VMK20-SF10R-50	10	22	26.2	32	3°	50	42	31	65	0.5		
	- 80			29.4							80	72	0.6
	-110			32							110	95.4	0.8
	-SF12R- 50	12	26	30.2						50	42	0.5	
	-80			80						57.3	80	0.7	
	-110			110							0.9		
	SF16R- 50	16	32	32						50	50	0.6	
	-80			80						80	33	50	0.7
	-110			110						110		0.9	

HSK HYBRID SHRINK FIT HOLDER (SET CODE)



Set Code: MMSF-B for prebalancing adjusting screws G2.5 30,000min⁻¹

MMSF-B

Standard Type

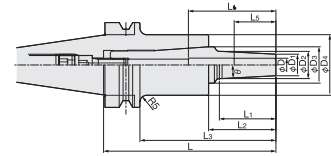

Taper	Code No.	øD	øD1	øD2	øD3	øD4	øD5	θ	L	L1	L2	L3	L4	L5	L6	Weight (Kg)
NBT40	NBT40-MMSF 3S-128B	3	6	10.2										10		1.7
	-MMSF 4S-128B	4	7	11.2										13		
	-MMSF 6S-128B	6	9	13.2				128	42	50	101			19		
	-MMSF 8S-128B	8	13	17.2										25		
	-MMSF 10S-128B			20.2												
	-158B	10	16	23.4				158	72	80	131				65	
	-188B			27	27	45	-	3°	188	105	110	161	-			
	-MMSF 12S-128B			23.2				128	42	50	101				31	
	-158B	12	19					158		80	131					
	-188B							188	76.4		110	161				
	-MMSF 16S-128B			27				128		50	101				50	
	-158B	16	24					158	28.7	80	131				33	
	-188B							188		110	161					
	NBT50	NBT50-MMSF 3S-128B	3	6	10.2										10	
-MMSF 4S-128B		4	7	11.2										13		
-MMSF 6S-128B		6	9	13.2				128	42	50	90			19		
-MMSF 8S-128B		8	13	17.2										25		
-MMSF 10S-128B				20.2												
-158B		10	16	23.4				158	72	80	120				65	
-188B				27	27	45	-	3°	188	105	110	150	-			
-MMSF 12S-128B				23.2				128	42	50	90				31	
-158B		12	19					158		80	120					
-188B								188	76.4		110	150				
-MMSF 16S-128B				27				128		50	90				50	
-158B		16	24					158	28.7	80	120				33	
-188B								188		110	150					

High Rigid Type

Taper	Code No.	øD	øD1	øD2	øD3	øD4	øD5	θ	L	L1	L2	L3	L4	L5	L6	Weight (Kg)		
NBT40	NBT40-MMSF10R-133B			25.2												2.0		
	-163B	10	22	29.4											65	2.1		
	-193B			32				3°	193	95.4	110	166				2.3		
	MMSF12R-133B			30.2					133	42	50	106			31	2.0		
	-163B	12	26		32	50	-		163		80	136	-		80	2.2		
	-193B								193	57.3		110	166				2.4	
	MMSF16R-133B			32					133	50	50	106					2.1	
	-163B	16	32					-	163	80	80	136			33	50	2.2	
	-193B								193	110	110	166						2.4
	NBT50	NBT50-MMSF10R-133B			25.2												4.5	
-163B		10	22	29.4											65	4.6		
-193B				32				3°	193	95.4	110	155					4.8	
MMSF12R-133B				30.2					133	42	50	95			31	4.5		
-163B		12	26		32	50	-		163		80	125	-		80	4.7		
-193B									193	57.3		110	155				4.9	
MMSF16R-133B				32					133	50	50	95					4.6	
-163B		16	32					-	163	80	80	125			33	50	4.7	
-193B									193	110	110	155						4.9

HSK HYBRID SHRINK FIT HOLDER (SET CODE)

Set Code: MMSF-B for prebalancing adjusting screws G2.5 30,000min⁻¹

MMSF-B

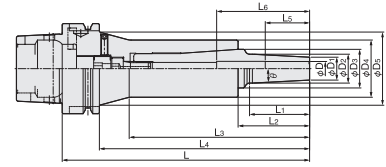

Standard Type



Taper	Code No.	øD	øD1	øD2	øD3	øD4	øD5	θ	L	L1	L2	L3	L4	L5	L6	Weight (Kg)
HSK63A	HSK 63A-MMSF 3S-173B	3	6	10.2										10		1.7
	-MMSF 4S-173B	4	7	11.2										13		
	-MMSF 6S-173B	6	9	13.2					173	42	50	126	147	19		
	-MMSF 8S-173B	8	13	17.2										25		
	-MMSF 10S-173B			20.2												
	-203B	10	16	23.4					203	72	80	156	177		65	
	-233B			27	27	40	51.2	3°	233	105	110	186	207		31	
	-MMSF 12S-173B			23.2					173	42	50	126	147			
	-203B	12	19						203		80	156	177			
	-233B								233	76.4		110	186	207		
	-MMSF 16S-173B			27					173		50	126	147		50	
	-203B	16	24						203	28.7	80	156	177		33	
	-233B								233		110	186	207			
	HSK100A	HSK 100A-MMSF 3S-180B	3	6	10.2										10	
-MMSF 4S-180B		4	7	11.2										13		
-MMSF 6S-180B		6	9	13.2					180	42	50	123.5	151	19		
-MMSF 8S-180B		8	13	17.2										25		
-MMSF 10S-180B				20.2												
-210B		10	16	23.4					210	72	80	153.5	181		65	
-240B				27	27	40	55.5	3°	240	105	110	183.5	211		31	
-MMSF 12S-180B				23.2					180	42	50	123.5	151			
-210B		12	19						210		80	153.5	181			
-240B									240	76.4		110	183.5	211		
-MMSF 16S-180B				27					180		50	123.5	151		50	
-210B		16	24						210	28.7	80	153.5	181		33	
-240B									240		110	183.5	211			

High Rigid Type

Taper	Code No.	øD	øD1	øD2	øD3	øD4	øD5	θ	L	L1	L2	L3	L4	L5	L6	Weight (Kg)
HSK63A	HSK 63A-MMSF10R-173B			26.2												2.1
	-203B	10	22	29.4					173	42	50	139	147		65	
	-233B			32					203	72	80	169	177			
	MMSF12R-173B			30.2					233	95.4	110	199	207		31	
	-203B	12	26		32	47	51.3	3°	173	42	50	139	147		80	
	-233B								203		80	169	177			
	-233B								233	57.3		110	199	207		
	MMSF16R-173B			32					173	50	50	139	147			
HSK100A	NB100A-MMSF10R-180B			26.2												3.5
	-210B	10	22	29.4					180	42	50	133.5	151		65	
	-240B			32					210	72	80	163.5	181			
	MMSF12R-180B			30.2					240	95.4	110	193.5	211		31	
	-210B	12	26		32	47	55.5	3°	180	42	50	133.5	151		80	
	-240B								210		80	163.5	181			
	-240B								240	57.3		110	193.5	211		
	MMSF16R-180B			32					180	50	50	133.5	151			
HSK100A	-210B	16	32					-	203	80	80	169	177		33	50
	-233B								233	110	110	199	207			
	-210B								210	80	80	163.5	181			
	-240B								240	110	110	193.5	211			